

SURVEY & REMONUMENTATION

OCT 24 1994

COMMISSION

OTTAWA COUNTY REMONUMENTATION LAND CORNER RECORDATION CERTIFICATE Filing Requirement of Act 74, Mich. P.A. 1970

RECORDED

94 OCT -7 PM 12:33

Phyllis Carlsson
REGISTER OF DEEDS
OTTAWA COUNTY, MI

For corners in

Ottawa (County) Located In: Corner Code #

- Public Land Survey T 6N R 14W F-5, Sec. 14 COR
T _____ R _____ Sec. 9, Blendon
T _____ R _____
T _____ R _____
- Property Controlling S _____ T _____ R _____
in Section S _____ T _____ R _____
- Miscellaneous S _____ T _____ R _____
Property in Sec. S _____ T _____ R _____
- Lot No. _____, Recorded Plat _____
- Private Claims _____

Register of Deeds Stamp & File Number

I, Randal D. Feenstra in a field survey on May 9, 19 94, do hereby certify that under requirements of P.A. 74, Michigan P.A. of 1970, the corner points mentioned in lines 1 and 2 above were in conformance with regulations and rules therefore as required in the current manual of survey instructions of the United States Department of the Interior, Bureau of Land Management or by a decree of a Court of Law and/or that the corner points mentioned in lines 3, 4 and 5 above were in conformance with the rules of the Michigan Board of Land Surveyors or by a Decree of a Court of Law; established, re-established, monumented, re-monumented, recovered, found as expressed below:

NOTE: Not more than 4 corners, all in the same town and range, may be recorded on this certificate.

A. Description of original monument and accessories and/or subsequent restoration:

G.L.O. (1932)	L-2, PG. 235 (1973)	L-4, Pg. 169 (1981)
6" Beech S01°E 7.9	Found 3/4" Pipe	Set Cast Iron Monument
30" Hemlock N45.6°E 16.5	20" Cherry NNE 48.24	PP SE 20.62
POST	Power Pole SSE 20.39	Twin 12" Cherry NNE 48.41
Samuel Marrs		8" Pine N 66.31
		5" Pine N 65.23

B. Description of corner evidence found and/or method applied in restoring or reestablishing corner:

Found: Cast Iron Monument - accepted as a careful and faithful perpetuation of the position of the original corner.
Found Witnesses:
Nail & tag N side PP S25°W 20.65
Nail W side 10" Pine N50°W 65.21

PA. 345 OTTAWA COUNTY

PEER APPROVED 8/22/94

Randal D. Feenstra

C. Description of monument for corner and accessories established to perpetuate locating the position of the corner:

F-5, Cast Iron Monument
O.C. Remon. Nail & tag W side 4" Oak S 78.76
O.C. Remon. Nail & tag W side PP S25°W 20.85
O.C. Remon. Nail & tag SW side 10" Pine N50°W 64.97
O.C. Remon. Nail & tag W side Fence Corner Post N'26.51
± 6' South of Polk Road CL

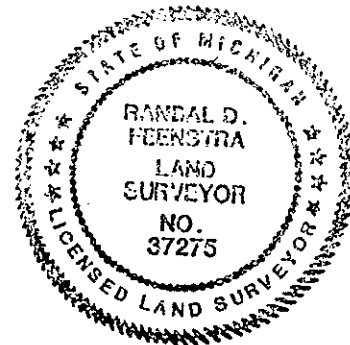

Signed by Randal D. Feenstra

Date May 9, 1994

Surveyor's Michigan License No. 37275