

OTAWA
REMONUMENTATION

FEB 18 1994

OTAWA COUNTY REMONUMENTATION
LAND CORNER RECORDATION CERTIFICATE
Filing Requirement of Act 74, Mich. P.A. 1970

RECORDED

93 NOV -8 PM 1:58

Daphne Childman
REGISTER OF DEEDS
OTTAWA COUNTY, MI

For corners in COMMISSION

Ottawa
(County)

Located In:

Corner Code ##

- | | | |
|-------------------------|--------------------------|-------------------------|
| 1. Public Land Survey | T <u>6N</u> R <u>14W</u> | <u>G-9, SE COR.</u> |
| | T _____ R _____ | <u>Sec. 21, Blendon</u> |
| | T _____ R _____ | _____ |
| | T _____ R _____ | _____ |
| 2. Property Controlling | S _____ T _____ R _____ | _____ |
| in Section | S _____ T _____ R _____ | _____ |
| 3. Miscellaneous | S _____ T _____ R _____ | _____ |
| Property in Sec. | S _____ T _____ R _____ | _____ |

Register of Deeds Stamp & File Number

4. Lot No. _____, Recorded Plat _____
5. Private Claims _____

I, Randal D. Feenstra in a field survey on October 13, 19 93, do hereby certify that under requirements of P.A. 74, Michigan P.A. of 1970, the corner points mentioned in lines 1 and 2 above were in conformance with regulations and rules therefore as required in the current manual of survey instructions of the United States Department of the Interior, Bureau of Land Management or by a decree of a Court of Law and/or that the corner points mentioned in lines 3, 4 and 5 above were in conformance with the rules of the Michigan Board of Land Surveyors or by a Decree of a Court of Law; established, re-established, monumented, re-monumented, recovered, found as expressed below:

NOTE: Not more than 4 corners, all in the same town and range, may be recorded on this certificate.

A. Description of original monument and accessories and/or subsequent restoration:

G-9:

L.C.R.C.#L-1, P-177 (11-29-71)
Monument Box

L.C.R.C.# L-5, P-124 (6-26-84)

Cast Iron Monument
Wood Guard Posts
Guy Pole
CL Street sign
P.Pole

SSE 66.90'
NE 47.62'
NW 50.48'
SW 61.63'

| | A | B | C | D | E | F | G | H | I | J | K | L | M |
|----|----|----|----|----|----|----|---|---|---|---|---|---|---|
| 2 | 6 | 5 | 4 | 3 | 2 | 1 | | | | | | | |
| 3 | | | | | | | | | | | | | |
| 4 | 7 | 8 | 9 | 10 | 11 | 12 | | | | | | | |
| 5 | | | | | | | | | | | | | |
| 6 | 18 | 17 | 16 | 15 | 14 | 13 | | | | | | | |
| 7 | | | | | | | | | | | | | |
| 8 | 19 | 20 | 21 | 22 | 23 | 24 | | | | | | | |
| 9 | | | | | | | | | | | | | |
| 10 | 30 | 29 | 28 | 27 | 26 | 25 | | | | | | | |
| 11 | | | | | | | | | | | | | |
| 12 | 31 | 32 | 33 | 34 | 35 | 36 | | | | | | | |
| 13 | | | | | | | | | | | | | |

3. Description of corner evidence found and/or method applied in restoring or reestablishing corner:

G-9: Found Cast Iron Monument in Box, accepted as a careful and faithful perpetuation of the position of the original corner.

| | | |
|-------------------------|-------|--------|
| PK Nail in N. side P.P. | S50°W | 61.39' |
| PK Nail in S. side P.P. | N50°E | 47.58' |
| CL Street sign | N45°E | 50.62' |

C. Description of monument for corner and accessories established to perpetuate locating the position of the corner:

G-9: Cast Iron Monument in Box

| | | |
|--|-------|--------|
| O.C. Remon. Nail & Tag in N. side P.P. | S50°W | 61.39' |
| O.C. Remon. Nail & Tag in S. side P.P. | N50°E | 47.56' |
| "X" in N. side 60" CSP | N35°E | 47.65' |
| "X" in S. side 60" CSP | S35°E | 48.55' |

8' E. and 1' S. of CL "X" Port Sheldon & 72nd Ave.

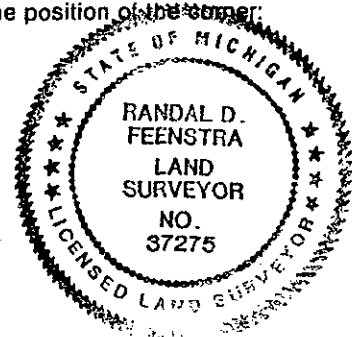

Signed by *Randal D. Feenstra* Date 10-13-93

Surveyor's Michigan License No. 37275