

# SURVEY & REMONUMENTATION

APR 05 1996

## COMMISSION

### OTTAWA COUNTY REMONUMENTATION LAND CORNER RECORDATION CERTIFICATE Filing Requirement of Act 74, Mich. P.A. 1970

For corners in  
Ottawa

(County)

Located In:

Corner Code #

1. Public Land Survey

Blendon Twp.

T 6N R 14W

G-10, W 1/4 cor.

T R

Sec. 27

T R

T R

2. Property Controlling  
in Section

S T R

S T R

3. Miscellaneous

S T R

Property in Sec.

S T R

4. Lot No. , Recorded Plat

5. Private Claims

RECORDED

95 NOV 29 PM 1:44

*Robert R. Hallman*  
REGISTER OF DEEDS  
OTTAWA COUNTY, MI

Register of Deeds Stamp & File Number

Randal D. Feenstra

November 6

95

I, Randal D. Feenstra, in a field survey on November 6, 1995, do hereby certify that under requirements of P.A. 74, Michigan P.A. of 1970, the corner points mentioned in lines 1 and 2 above were in conformance with regulations and rules therefore as required in the current manual of survey instructions of the United States Department of the Interior, Bureau of Land Management or by a decree of a Court of Law and/or that the corner points mentioned in lines 3, 4 and 5 above were in conformance with the rules of the Michigan Board of Land Surveyors or by a Decree of a Court of Law; established, re-established, monumented, re-monumented, recovered, found as expressed below:

**NOTE: Not more than 4 corners, all in the same town and range, may be recorded on this certificate.**

A. Description of original monument and accessories and/or subsequent restoration:

G.L.O. (1832)

L-1, P-177, 1971

L-5, P-119, 1984

Calvin Britain

Boat Spike

C.I.M.

8" Beech S 88°E 20 lks.

14" Cherry

NW 65.95'

10" Cherry SE 49.64'

5" Beech N10°W 14 lks.

24" Cherry

NE 52.95'

37" Oak SW 66.69'

12" Cherry

SE 69.69'

18" Cherry NNW 66.83'

24" Oak

SW 65.69'

T.P.

NW 41.73'

B. Description of corner evidence found and/or method applied in restoring or reestablishing corner:

Found: C.I.M. in box

Accepted as a careful and faithful perpetuation of the position of the original corner.

Nail in S. side P.Pole

NW 38.88'

Nail in S. side 18" Cherry

WNW 66.78'

Nail in N. side 10" Cherry

SE 49.33'

P.A. 345 OTTAWA COUNTY

PEER APPROVED 11/20/95

*Randal D. Feenstra*  
DON

C. Description of monument for corner and accessories established to perpetuate locating the position of the corner:

G-10 C.I.M. in Box

Ottawa County Remon Nail & Tag in S side P. Pole 320° 38.86'

Ottawa County Remon Nail & Tag in S side 18" Cherry 290° 66.78'

Ottawa County Remon. Nail & Tag in N. side 42" Oak 225° 66.46'

Ottawa County Remon. Nail & Tag in N side 10" Cherry 110° 49.82'

1' E of centerline "X" 72nd Ave. & Bingham

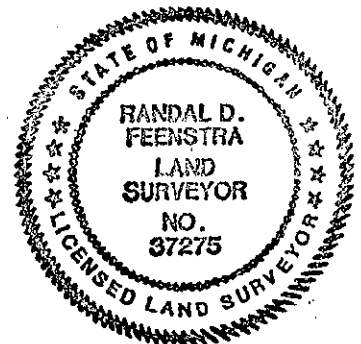

signed by

*Randal D. Feenstra*

Date November 6, 1995

Surveyor's Michigan License No.

37275

FORM APPROVED BY MICHIGAN STATE BOARD OF LAND SURVEYORS, JAN. 28, 1971  
REVISED MAY 14, 1975  
REVISED JAN., 1983