

FEB 24 2000

OTTAWA COUNTY REMONUMENTATION
LAND CORNER RECORDATION CERTIFICATE
Filing Requirement of Act 74, Mich. P.A. 1970

SECTION

For corners in

OTTAWA
(County)

Located In: Corner Code #
BLENDON TOWNSHIP

1. Public Land Survey T 6N R 14W G-13
T R SW Corner
T R Section 34
T R
2. Property Controlling S T R
in Section S T R
3. Miscellaneous S T R
Property In Sec. S T R

4. Lot No. , Recorded Plat
5. Private Claims

RECORDED

99 SEP 23 PM 3: 20

Sam Sibley
REGISTER OF DEEDS
OTTAWA COUNTY, MI

Register of Deeds Stamp & File
Number

I, Rodney D. Unema, in a field survey on September 16, 19 99 do hereby state that under requirements of P.A. 74, Michigan P.A. of 1970, the corner points mentioned in lines 1 and 2 above were in conformance with regulations and rules therefore as required in the current manual of survey instructions of the United States Department of the Interior, Bureau of Land Management or by a decree of a Court of Law and /or that the corner points mentioned in lines 3, 4 and 5 above were in conformance with the rules of the Michigan Board of Land Surveyors or by a Decree of a Court of Law; established, re-established, monumented, recovered, found as expressed below.

NOTE: Not more than 2 corners, all in the same town and range, may be recorded on this certificate.

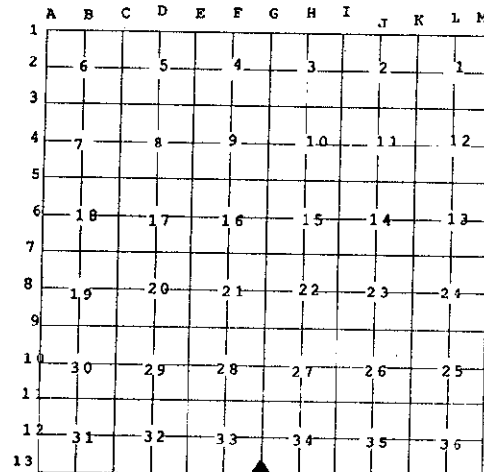

A. Description of original monument and accessories and/or subsequent restoration:

G-13 SW Corner, Section 34

Nov, 1831 G.L.O. Survey by
Sylvester Sibley
Set P. cor.
9" Sugar N77°W 5 links
6" Beech N78°E 54 links

July 9, 1974 (Barnett)
Liber 2, Page 527
Found "T" Iron in Mon. Box
Gas marker post NE 31.00'
Centerline street sign SE 25.40'
P. Pole SE 36.70'
P. Pole NW 89.90'

March 18, 1988 (Greer)
Liber 5, page 297
"T" Iron in Mon. Box
P. Pole SE 36.51'
P. Pole NW 89.90'
Tel. Pole SW 97.78'
W. cor. hse fnd. NE 149.86'

B. Description of corner evidence found and/or method applied in restoring or reestablishing corner:

G-13 Found "T" Iron in Mon. Box

Found "T" Iron @ G-1 T5N, R14W West 48.17'
Found PK in SW side P. Pole N55°W 90.22'
W. corner hse foundation N34°E 149.93'
Found PK nail in E. side P. Pole S4°W 36.75'
Broken off old P. Pole N54°W 89.7' to center

Accepted "T" Iron as a careful and faithful perpetuation of the position of the original corner, and replaced with standard Ottawa County Cap on 3/4" x 24" Bar.

C. Description of monument for corner and accessories established to perpetuate locating the position of the corner:

G-13 Ottawa County Cap on 3/4" x 24" Bar in Mon. Box
Westerly corner of conc. fndn, hse #7185 N34°E 149.87'
Southerly garage cor of conc fndn hse #7185 N62°E 149.14'
Set nail & O.C. remon tag in E. sde P. Pole S4°W 36.88'
Set nail & O.C. remon tag in NE sde P. Pole N55°W 90.00'
Centerline of gravel road to East (New Holland St.) North +/- 3'
Centerline of BT road to North (72nd Avenue) West +/- 2'
G-1 T5N, R14W West 48.17'

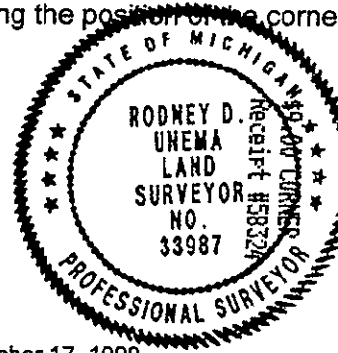

Signed by Rodney D. Unema
Surveyor's Michigan License No. 33987

Date September 17, 1999