

# SURVEY & REMONUMENTATION

OCT 24 1994

COMMISSION

OTTAWA COUNTY REMONUMENTATION

LAND CORNER RECORDATION CERTIFICATE

Filing Requirement of Act 74, Mich. P.A. 1970

RECORDED

94 OCT -7 PM 12:33

For corners in

Ottawa

(County)

Located In:

Corner Code ##

1. Public Land Survey

T 6N R 14W

I-7, NE COR

Sec. 22, Blendon

2. Property Controlling

S T R

in Section

S T R

3. Miscellaneous

S T R

Property in Sec.

S T R

4. Lot No.

, Recorded Plat

5. Private Claims

I, Randal D. Feenstra in a field survey on May 4, 1994

do hereby certify that under requirements of P.A. 74, Michigan P.A. of 1970, the corner points mentioned in lines 1 and 2 above were in conformance with regulations and rules therefore as required in the current manual of survey instructions of the United States Department of the Interior, Bureau of Land Management or by a decree of a Court of Law and/or that the corner points mentioned in lines 3, 4 and 5 above were in conformance with the rules of the Michigan Board of Land Surveyors or by a Decree of a Court of Law; established, re-established, monumented, re-monumented, recovered, found as expressed below:

**NOTE:** Not more than 4 corners, all in the same town and range, may be recorded on this certificate.

POST Samuel Marrs

A. Description of original monument and accessories and/or subsequent restoration:

L.O. (1832) - 14" Beech N75°E 8.6'; 6" Beech N30°W 7.9' Liber 2, Page 705 (1974) - 1" Iron in on. Box; NE cor. Blendon Hall SW 62.09; Pk in light pole SE 36.11; Pk in P. Pole NE 39.33 Liber 3, Page 12 (1975) - 1" Iron; Spike in E side 18" Maple SSE 126.62; Spike in S side 14" Oak SW 148.67; Spike in 20" Oak ESE 155.76; CL street sign post SE 34.58 Liber 4, Page 256 (1981) - Cast Iron Monument; Street Sign SE 35.78; Fence Post NW 37.57; Wood Post next to Tele. Ped. NE 44.70; Sassafras SE 79.43 Liber 5, Page 281 (1987) - Cast Iron Monument; CL street sign SE 42.84; Pk in NW side wood post next to Tele. box NE 44.69; CL stop sign NNW 45.24; Nail & Tag in E side 24" Maple SSE 26.60.

B. Description of corner evidence found and/or method applied in restoring or reestablishing corner:

Found: Cast Iron Monument - accepted as a careful and faithful perpetuation of the position of the original corner.

Found Witnesses:

1. Nail in SE side 4" Sassafras

2. Headed Nail in SE side 4" Sassafras

3. CL Stop sign

4. Headed Nail & Tag in E side 30" Maple

5. Nail in NW side wood post next to Tele. box

SE 79.37'

NNW 45.93'

SSE 126.52'

PA. 345 OTTAWA COUNTY

PEER APPROVED

*Randal D. Feenstra*

C. Description of monument for corner and accessories established to perpetuate locating the position of the corner:

I-7 Cast Iron Monument

O.C. Remon. Nail & Tag in S side PP

O.C. Remon. Nail & Tag in W side PP

O.C. Remon. Nail & Tag in W side 30" Maple

O.C. Remon. Nail & Tag in NE side 4" Sassafras

On CL Tyler and 1' E of CL 64th Avenue.

N65°W 85.92'

N25°W 67.26'

S15°E 126.26'

S55°E 79.52'

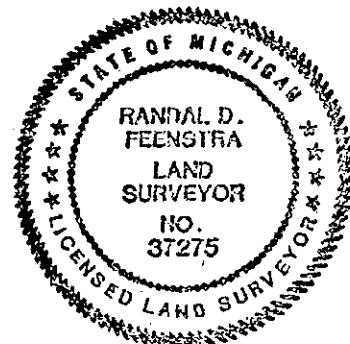

Signed by

*Randal D. Feenstra*

Date

May 4, 1994

Surveyor's Michigan License No.

37275