

SURVEY & REMONUMENTATION

APR 29 1996

COMMISSION

JUDITH D. ROEHM
Ontonagon County
LC 3/ 352 JEM Fee: 9.00
Page 1 of 1

LAND CORNER RECORDATION CERTIFICATE Filing Requirement of Act 74, Mich. P.A. 1970

For corners in
Ontonagon
(County) Located In: Corner Code #

1. Public Land Survey T 52N R 39W 004
T 52N R 39W
T 52N R 39W
OTHER T 52N R 39W 004
2. Property Controlling S 52N T 39W R 004
in Section S 52N T 39W R 004
3. Miscellaneous S 52N T 39W R 004
Property in Section S 52N T 39W R 004
4. Lot No. _____, Recorded Plat _____
5. Private Claims _____

Register of Deeds Stamp & File Number

I, Joseph C. Domitrovich, in a field survey on October 2, 19 95, do hereby certify that under requirements of P.A. 74, Michigan P.A. of 1970, the corner points mentioned in lines 1 and 2 above were in conformance with regulations and rules therefore as required in the current manual of survey instructions of the United States Department of the Interior, Bureau of Land Management or by a decree of a Court of Law and/or that the corner points mentioned in lines 3, 4 and 5 above were in conformance with the rules of the Michigan Board of Professional Surveyors or by a Decree of a Court of Law; established, re-established, monumented, re-monumented, recovered, found as expressed below:

NOTE: Not more than 4 corners, all in the same town and range, may be recorded on this certificate.

A. Description of original monument and accessories and/or subsequent restoration:

Meander Corner Sections 16 and 17, T52N, R39W

1845 - William A. Burt intersected Lake Superior 4.28 chains (282.48') north of the corner of Sections 16, 17, 20 and 21, and set a meander post.
12" Spruce S 25° E 20 links

B. Description of corner evidence found and/or method applied in restoring or reestablishing corner:

The shoreline of Lake Superior has eroded considerably since the original corner was established and no evidence of it remains.

Re-established section line on the extension of a line passing through the 1/4 Corner and Section Corner to the south.

Established a witness corner to the meander corner on this line and 125' north of the corner of Section 16, 17, 20 and 21.

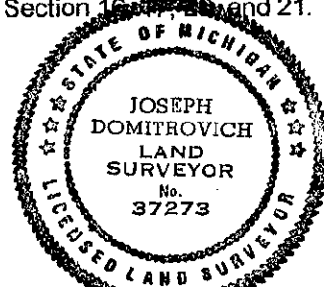

(Research on file with County Remonumentation Representative.)

C. Description of monument for corner and accessories established to perpetuate locating the position of the corner:

Corner is a 3/4" x 6' long aluminum rod with a 3" diameter stamped aluminum cap and falls 76' south of the shore of Lake Superior.

8" Soft Maple N 80° E 16.76'
16" White Birch S 40° E 14.70'
12" White Birch S 18° W 25.95'

Corner of Sections 16, 17, 20 & 21 (Stamped Monument)

Witness Corner to Meander Corner Sections 17 & 20 (Stamped Monument)

Sign Post North 1.03'

PEER GROUP APPROVED

Earl W. Applekamp
COUNTY REPRESENTATIVE

South 125.00'
S 52° W 196.15'

10-18-95

NOTE: Bearings are magnetic. Distances are to nail in side of witness objects unless noted.

Signed by J. C. Domitrovich

Date 10/18/95

Surveyor's Michigan License No. 37273

FORM APPROVED BY MICHIGAN STATE BOARD OF PROFESSIONAL SURVEYORS, JAN. 28, 1971
REVISED MAY 14, 1975
REVISED JAN., 1983