

MICHIGAN
DEPARTMENT OF CONSERVATION
FORESTRY DIVISION



LAND CORNER RECORD

T. 21 N. R. 3 W

Roscommon COUNTY

DESCRIPTION OF CORNER Sec. corner common to Sections 32-33 on S. Boundary of Township

CORNER MONUMENT Set 1" pipe with 4" aluminum cap

DATE MONUMENT PLACED AND WITNESSED November 15, 1966

WITNESSES TO CORNER.....

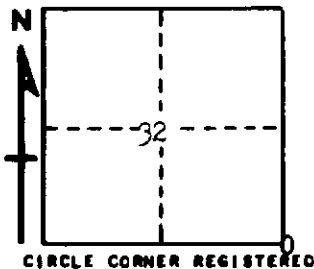

8" R. Pine N 42 E 33.1

AND

DESCRIPTION IN DETAIL AS TO HOW CORNER WAS LOCATED AND IDENTIFIED OR RESTORED.

This corner was set during a survey of the county line through this township. Set corner on line over 1/4 and section corner east at double distance from 1/4 corner. This falls at probable position of previous Schaaf corner, although any previous corner was removed during road construction or planting. Evidence of pits NE and SW 50 links.

SURVEYOR'S SEAL

SIGNED Kenneth J. Ostling DATE Nov. 29, 1966
REGISTERED LAND SURVEYOR #10068