

SURVEY & REMONUMENTATION

APR 14 1998

LIBER

2 PAGE 185

RECEIVED FOR RECORD

REMONUMENTATION
SECTION

LAND CORNER RECORDATION CERTIFICATE
Filing Requirement of Act 74, Mich. P.A. 1970

97 DEC -2 AM 9:11

LIBER NO. 2 PAGE NO. 185

ESTHER LEE
REGISTER OF DEEDS
SANILAC CO. MICHIGAN

For corners in CUSTER TOWNSHIP

<u>Sanilac</u> (County)	Located In:	Corner Code #
1. Public Land Survey	T12N R14E	E - 10
	T R	
	T R	
	T R	
2. Property Controlling in Section	S T R	
	S T R	
3. Miscellaneous Property in Sec.	S T R	
	S T R	

SURVEY &
REMONUMENTATION

JAN 08 1998

SECTION

Register of Deeds Stamp & File Number

4. Lot No. _____, Recorded Plat _____
5. Private Claims _____

I, John A Millettics, in a field survey on July 14 1997 do hereby state that under requirements of P.A. 74, Michigan P.A. of 1970, the corner points mentioned in lines 1 and 2 above were in conformance with regulations and rules therefore as required in the current manual of survey instructions of the United States Department of the Interior, Bureau of Land Management or by a decree of a Court of Law and /or that the corner points mentioned in lines 3, 4 and 5 above were in conformance with the rules of the Michigan Board of Land Surveyors or by a Decree of a Court of Law; established, re-established, monumented, recovered, found as expressed below:

NOTE: Not more than 2 corners, all in the same town and range, may be recorded on this certificate.

	A	B	C	D	E	F	G	H	I	J	K	L	M
1													
2	6		5		4		3		2		1		
3													
4	7		8		9		10		11		12		
5													
6	18		17		16		15		14		13		
7													
8	19		20		21		22		23		24		
9													
10	30		29		28		27		26		25		
11													
12	31		32		33		34		35		36		
13													

A. Description of original monument and accessories and/or subsequent restoration:

E - 10

GLO Notes

Set 1/4 Section Post.

Hemlock 10 N87°E 10

Hemlock 15 S69°W 19

Old Survey Liber, Survey dated April 1894 by Galbraith, and survey dated Aug 1906 by Nicol
Act 74 None
Act 132 Liber 3 Page 621

B. Description of corner evidence found and/or method applied in restoring or reestablishing corner:

E - 10

Found Moun Box in place with iron

APPROVED PEER BOARD MEETING
NOV. 26, 1997 jm

C. Description of monument for corner and accessories established to perpetuate locating the position of the corner:

E - 10

E 1/4 Corner Section 29 T12N-R14E Custer Twp.

Monu Box in place with iron and cap

East 49.46 feet to a 1/2" Iron Bar

S80°W 63.45 feet to the NE Cor of a Building

N70°W 46.50 feet to a nail in a 30" Poplar

N40°W 79.96 feet to a nail in a 24" Maple

South 2664.22 feet to the SE Cor Section 29

North 2664.00 feet to the NE Cor Section 29

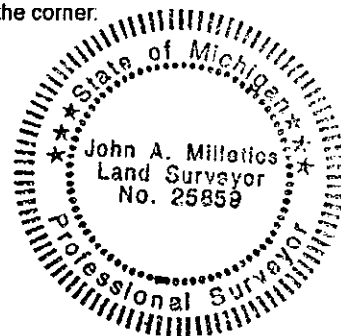

Signed by John A. Millettics

Date Nov 12, 1997

Surveyor's Michigan License No. 25859