

RECEIVED FOR RECORD
98 DEC -1 AM 9:10
LIBER NO. 2 PAGE NO. 278

REMONUMENTATION

LAND CORNER RECORDATION CERTIFICATE
Filing Requirement of Act 74, Mich. P.A. 1970

For corners in

Sanilac
(County)

Located In:

Corner Code #

- 1. Public Land Survey T14N R12E H-13
- 2. Property Controlling in Section S T R
- 3. Miscellaneous Property in Sec. S T R

MICHELE VAN NORMAN
REGISTER OF DEEDS
SANILAC CO., MICHIGAN

Register of Deeds Stamp & File Number

- 4. Lot No. , Recorded Plat
- 5. Private Claims

I, John A. Milletics, in a field survey on Nov 1, 1998 do hereby state that under requirements of P.A. 74, Michigan P.A. of 1970, the corner points mentioned in lines 1 and 2 above were in conformance with regulations and rules therefore as required in the current manual of survey instructions of the United States Department of the Interior, Bureau of Land Management or by a decree of a Court of Law and/or that the corner points mentioned in lines 3, 4 and 5 above were in conformance with the rules of the Michigan Board of Land Surveyors or by a Decree of a Court of Law; established, re-established, monumented, recovered, found as expressed below:

NOTE: Not more than 2 corners, all in the same town and range, may be recorded on this certificate.

| | A | B | C | D | E | F | G | H | I | J | K | L | M |
|----|----|---|----|---|----|---|----|---|----|---|----|---|---|
| 1 | | | | | | | | | | | | | |
| 2 | 6 | | 5 | | 4 | | 3 | | 2 | | 1 | | |
| 3 | | | | | | | | | | | | | |
| 4 | 7 | | 8 | | 9 | | 10 | | 11 | | 12 | | |
| 5 | | | | | | | | | | | | | |
| 6 | 18 | | 17 | | 16 | | 15 | | 14 | | 13 | | |
| 7 | | | | | | | | | | | | | |
| 8 | 19 | | 20 | | 21 | | 22 | | 23 | | 24 | | |
| 9 | | | | | | | | | | | | | |
| 10 | 30 | | 29 | | 28 | | 27 | | 26 | | 25 | | |
| 11 | | | | | | | | | | | | | |
| 12 | 31 | | 32 | | 33 | | 34 | | 35 | | 36 | | |
| 13 | | | | | | | | | | | | | |

A. Description of original monument and accessories and/or subsequent restoration:

- 1- 13 GLO Notes - Hemlock 14 N72 1/2E 30; Hemlock 7 N40W 19 1/2
- Old Survey Liber - None
- Act 132 - None
- L.C.R.C. - None
- Road Comm - None

B. Description of corner evidence found and/or method applied in restoring or reestablishing corner:

- H - 13
- S 1/4 Corner Section 34 T14N-R12E
- Set 1/2" Iron Bar on line between the SE corner and the SW Corner of said Section at half distance
- West 2653.58 feet to the SW Corner Section 34
- East 2653.58 feet to the SE Corner Section 34

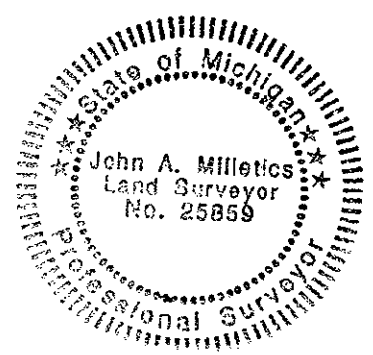

APPROVED PEER BOARD MEETING
NOV 30, 1998

C. Description of monument for corner and accessories established to perpetuate locating the position of the corner:

- H - 13
- S 1/4 Corner Section 34 T14N-R12E
- 1/2" Iron bar with cap
- West 2653.58 feet to the SW Corner Section 34
- East 2653.58 feet to the SE Corner Section 34
- S45°W 86.95 feet to a nail in a Power Pole
- South 33.00 feet to a 1/2" Iron
- North 33.00 feet to a 1/2" Iron

SURVEY &
REMONUMENTATION

JAN 15 1999

SECTION

Signed by John A. Milletics
Surveyor's Michigan License No. 25859

Date Nov 20, 1998