

SURVEY &  
REMONUMENTATION

MAY 07 1997

COMMISSION

LAND CORNER RECORDATION CERTIFICATE  
Filing Requirement of Act 74, Mich. P.A. 1970

For corners in

ST. JOSEPH

(County)

LEONIDAS TWP.

Located In:

Corner Code #

1. Public Land Survey

T 5S R 9W

D-3

2. Property Controlling  
in Section

S

T R

3. Miscellaneous

S

T R

Property in Sec.

S

T R

4. Lot No. , Recorded Plat

5. Private Claims

MAR. 11, 1994 &

I, WAYNE A. MOSTROM, in a field survey on NOV. 11, 1996 do hereby state that under requirements of P.A. 74, Michigan P.A. of 1970, the corner points mentioned in lines 1 and 2 above were in conformance with regulations and rules therefore as required in the current manual of survey instructions of the United States Department of the Interior, Bureau of Land Management or by a decree of a Court of Law and/or that the corner points mentioned in lines 3, 4 and 5 above were in conformance with the rules of the Michigan Board of Land Surveyors or by a Decree of a Court of Law; established, re-established, monumented, recovered, found as expressed below:

NOTE: Not more than 2 corners, all in the same town and range, may be recorded on this certificate.

LIBER 4 PAGE 270

STATE OF MICHIGAN  
ST. JOSEPH COUNTY  
FILED

5 DEC 96 12:34 P.M.

CYNTHIA JARRATT  
REGISTER OF DEEDS

Register of Deeds Stamp & File Number

	A	B	C	D	E	F	G	H	I	J	K	L	M
1													
2	6		5		4		3		2		1		
3													
4	7		8		9		10		11		12		
5													
6	18		17		16		15		14		13		
7													
8	19		20		21		22		23		24		
9													
10	30		29		28		27		26		25		
11													
12	31		32		33		34		35		36		
13													

A. Description of original monument and accessories and/or subsequent restoration:

1865 SURVEY BY GARDNER

STK. FROM OLD BEARINGS

1975 L.C.R.C. IN 2/298 & 3/84

STONE

METAL FENCEPOST = NW 44.56'

R.R. RAIL = SW 29.3'

1.5' S. OF CENTERLINE

1984 ROAD COMM. RECORDS

LARGE UPRIGHT STONE

16" ASH = N3°E 40.02'

STEEL A.P. = N43°W 44.5'

R.R. ANCHOR POST = S4°W 29.2'

B. Description of corner evidence found and/or method applied in restoring or reestablishing corner:

FOUND STONE IN MON. BOX

16" ASH = N3°E 40.02'

STL. A.P. = N43°W 44.50'

R.R. ANCHOR POST = S4°W 29.20'

RATIFIED BY PEER GROUP

IN ACCORDANCE WITH P.A. 345

ON Nov. 14, 1996

CO. REPRESENTATIVE

C. Description of monument for corner and accessories established to perpetuate locating the position of the corner:

SET 5/8" IRON BAR 6" LONG IN CONC. OVER STONE W/STD. CAP

SE COR. R.R. RAIL = N43°W 44.56'

N & W IN W. SIDE 24" ASH = N3°E 40.02'

NE COR. R.R. RAIL A.P. = S4°W 29.20'

Q GRAVEL RDWY = 1.5' NORTH

PROJ. OF FENCE TO SOUTH = WEST 5'

N & W IN E. SIDE 6" BLK LOCUST = S25°E 24.87'

N & W IN W. SIDE 6" ASH = N5°W 51.08'

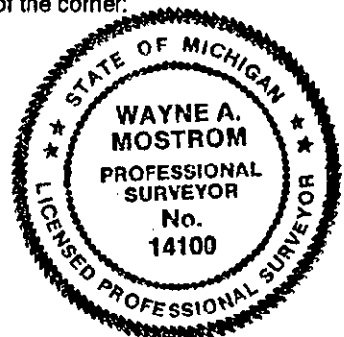

Signed by Wayne A. Mostrom  
Surveyor's Michigan License No. 14100

Date NOVEMBER 15, 1996

LIBER 4 PAGE 270