

# SCHOOLCRAFT COUNTY PEER GROUP APPROVED

DATE 10/15/97

LAND CORNER RECORDATION CERTIFICATE  
Filing Requirement of Act 74, Mich. P.A. 1970

SURVEY &  
REMONUMENTATION

JAN 21 1998

SECTION

For corners in

Schoolcraft  
(County)

Located In:

Corner Code #

1. Public Land Survey

T42N R16W

K-11

T R

T R

T R

2. Property Controlling  
in Section

S T R

S T R

3. Miscellaneous  
Property in Sec.

S T R

S T R

4. Lot No. , Recorded Plat

5. Private Claims

I, Thomas P. O'Brien, in a field survey on Nov. 5, 1997 do hereby state that under requirements of P.A. 74, Michigan P.A. of 1970, the corner points mentioned in lines 1 and 2 above were in conformance with regulations and rules therefore as required in the current manual of survey instructions of the United States Department of the Interior, Bureau of Land Management or by a decree of a Court of Law and/or that the corner points mentioned in lines 3, 4 and 5 above were in conformance with the rules of the Michigan Board of Land Surveyors or by a Decree of a Court of Law; established, re-established, monumented, recovered, found as expressed below:

NOTE: Not more than 2 corners, all in the same town and range, may be recorded on this certificate.

A. Description of original monument and accessories and/or subsequent restoration:

K-11 S W Corner Section 25

Aug. 12, 1850 - Algernon Merryweather D.S. set corner post.  
Cedar 10 in. N45E 8 lks. Do. 14 in. S55W 28 lks.

June 19, 1978 - Thomas P. O'Brien P.S. " set iron bar by proportionate measure."  
LCRC recorded Liber 1 page 182.

B. Description of corner evidence found and/or method applied in restoring or reestablishing corner:

K-11 Nov. 5, 1997 - Thomas P. O'Brien P.S. recovered iron bar w/ 21274 cap. Witnesses found verify corner location. Reset iron bar with Schoolcraft County Monument.

C. Description of monument for corner and accessories established to perpetuate locating the position of the corner:

K-11 Schoolcraft County Monument stamped to identify.

Witnesses: Fence post - S38°W - 45.35'  
Fence post - West - 18.00'  
Fence post - N16°W - 37.40'  
Fence post - S25°W - 91.72'

Thomas P. O'Brien

Signed by Thomas P. O'Brien P.S.

Surveyor's Michigan License No. 21274

Date December 19, 1997

Received & Filed this 23 day of  
Dec. 1997 at 3:02 PM

Sigrid I. Hedberg  
Schoolcraft Co. Reg. of Deeds

Register of Deeds Stamp & File Number

	A	B	C	D	E	F	G	H	I	J	K	L	M
1													
2	6		5		4		3		2		1		
3													
4	7		8		9		10		11		12		
5													
6	18		17		16		15		14		13		
7													
8	19		20		21		22		23		24		
9													
10	30		29		28		27		26		25		
11													
12	31		32		33		34		35		36		
13													

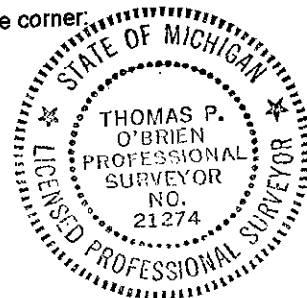

LIBER 4 PAGE: 148