

LAND CORNER RECORDATION CERTIFICATE
Filing Requirement of Act 74, Mich. P.A. 1970

For corners in
Schoolcraft

(County)

Located In:

Corner Code #

1. Public Land Survey

T 43N R 16W

E13

T R

T R

T R

2. Property Controlling
in Section

S 33

T 43N R 16W

15

S T R

3. Miscellaneous

S

T R

Property in Sec.

S

T R

Register of Deeds Stamp & File Number

4. Lot No. , Recorded Plat

5. Private Claims

Jul 28 2004

I, Stephan J. Szyszkoski, in a field survey on _____, 19____ do hereby state that under requirements of P.A. 74, Michigan P.A. of 1970, the corner points mentioned in lines 1 and 2 above were in conformance with regulations and rules therefore as required in the current manual of survey instructions of the United States Department of the Interior, Bureau of Land Management or by a decree of a Court of Law and /or that the corner points mentioned in lines 3, 4 and 5 above were in conformance with the rules of the Michigan Board of Land Surveyors or by a Decree of a Court of Law, established, re-established, monumented, recovered, found as expressed below:

NOTE: Not more than 2 corners, all in the same town and range, may be recorded on this certificate.

| | A | B | C | D | E | F | G | H | I | J | K | L | M |
|----|----|---|----|---|----|---|----|---|----|---|----|---|---|
| 1 | | | | | | | | | | | | | |
| 2 | 6 | | | 5 | | 4 | | 3 | | 2 | | 1 | |
| 3 | | | | | | | | | | | | | |
| 4 | 7 | | 8 | | 9 | | 10 | | 11 | | 12 | | |
| 5 | | | | | | | | | | | | | |
| 6 | 18 | | 17 | | 16 | | 15 | | 14 | | 13 | | |
| 7 | | | | | | | | | | | | | |
| 8 | 19 | | 20 | | 21 | | 22 | | 23 | | 24 | | |
| 9 | | | | | | | | | | | | | |
| 10 | 30 | | 29 | | 28 | | 27 | | 26 | | 25 | | |
| 11 | | | | | | | | | | | | | |
| 12 | 31 | | 32 | | 33 | | 34 | | 35 | | 36 | | |
| 13 | | | | | | | | | | | | | |

A. Description of original monument and accessories and/or subsequent restoration:

(E13) Corner common to Sections 32-33 T43N-R16W and Sections 4-5 T42N-R16W. 1841 - Established by Wm. Burt: West on South side Sec. 33...80.00 Set post cor. Sec. 32 & 33. Spruce 7 N50E 35 links, Tamarack 5 N41W 7 links. Additional NBTs by A. Merryweather 1850: Spruce 8 S45E 12 links, Spruce 5 S27W 12 links.

(15-Sec. 33) West 1/16 corner between Section 33 T43N-R16W and Section 4 T42N-R16W. Not established in the original survey.

B. Description of corner evidence found and/or method applied in restoring or reestablishing corner:

(E13) The original post and accessories were not recovered. Reestablished the corner by single proportionate measurement and on the curved township line between Section corners 5273.77' east and west.

(15-Sec. 33) Established the corner midway and on the curved township line between Section corner 1318.44' west and Quarter corner 1318.44' east.

C. Description of monument for corner and accessories established to perpetuate locating the position of the corner:

(E13) Set 1"IDx36" I.pipe with 4" alum.
MDNR cap. Blazed, scribed, and set

measuring nails in:

12" Cedar S80W 26.4' "S5 NBT"

4" Tamarack N49W 28.1' "S32 NBT"

4" Spruce N08W 16.0' do

4" Tamarack S87E 16.85' "S4 NBT"

Bearings are magnetic. Distances are to
nail with tag.

(15) Set 1"IDx36" I.pipe with 4" alum.

MDNR cap. Blazed, scribed, and set

measuring nails in:

5" Tamarack North 10.0' "W1/16 BT"

24" W.Pine N26E 29.4' do

8" W.Pine N85W 25.0' do

5" Tamarack S46W 29.1' do

Bearings are magnetic. Distances are to
nail with tag.

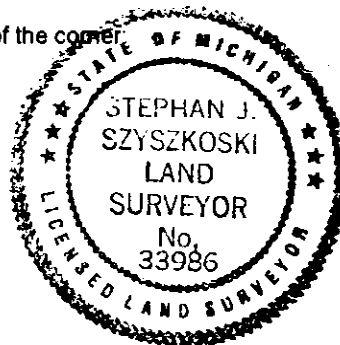

Signed by Stephan J. Szyszkoski

Date 9/14/04

Surveyor's Michigan License No. 33986