

LAND CORNER RECORDATION CERTIFICATE
Filing Requirement of Act 74, Mich. P.A. 1970 as Amended

For corners in

Schoolcraft (County)	Located In:	Corner Code #
1. Public Land Survey	T 47N R 13W	62
	T R	
	T R	
	S T R	
2. Property Controlling in Section	S T R	
	S T R	
3. Miscellaneous Property in Sec.	S T R	
	S T R	
4. Lot No. , Recorded Plat		
5. Private Claims		

Register of Deeds Stamp & File
Number

	A	B	C	D	E	F	G	H	I	J	K	L	M
1													
2	6		5			4		3		2		1	
3													
4	7		8			9		10		11		12	
5													
6	18		17			16		15		14		13	
7													
8	19		20			21		22		23		24	
9													
10	30		29			28		27		26		25	
11													
12	31		32			33		34		35		36	
13													

Jun 23 2005

I, Stephan J. Szyszkoski, in a field survey on _____, 20____ do hereby state that under requirements of P.A. 74, Michigan P.A. of 1970, the corner points mentioned in lines 1 and 2 above were in conformance with regulations and rules therefore as required in the current manual of survey instructions of the United States Department of the Interior, Bureau of Land Management or by a decree of a Court of Law and /or that the corner points mentioned in lines 3, 4 and 5 above were in conformance with the rules of the Michigan Board of Land Surveyors or by a Decree of a Court of Law; established, re-established, monumented, recovered, found as expressed below:

NOTE: Not more than 2 corners, all in the same town and range, may be recorded on this certificate.

A. Description of original monument and accessories and/or subsequent restoration:

(G2) Quarter corner common to Sections 3 and 4. 2000 - Perpetuated by the undersigned in the 1970 position of record. Found 1" pipe with 4" aluminum cap, set measuring nails in: 24" B.Cherry S59W 33.6', 3" Spruce S29E 22.9', 28" W.Pine S38W 9.5', 24" Cherry N88W 40.1'.

B. Description of corner evidence found and/or method applied in restoring or reestablishing corner:

(G2) Recovered the monument of record, in good condition, buried in the road shoulder, approximately 10.5 south of the road centerline, at record bearing and distance from the remaining 2000 witnesses. The 3" Spruce S29E and the 28" W.Pine S38W are now gone. Left the monument in place and made new witnesses.

C. Description of monument for corner and accessories established to perpetuate locating the position of the corner:

(G2) Found 1" ID I.pipe with 4" alum. cap. Set measuring nails in:
24" B.Cherry S84E 85.2' mrkd "1/4S NBT"
11" W.Pine S54E 101.7' do
The 2000 wits:
24" B.Cherry S59W 33.6' w/marks & nail
24" B.Cherry N88W 40.1' do
Bearings are magnetic. Distances are to nail with tag.

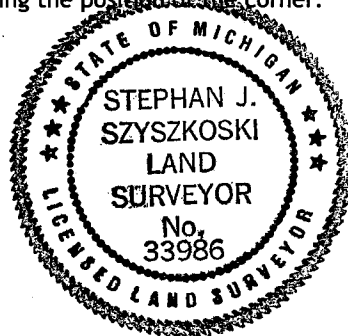

Signed by Stephan J. Szyszkoski
Surveyor's Michigan License No. 33986

Date 3/12/07

For the Michigan Department of Natural Resources, Office of Land and Facilities