

**SURVEY &
REMONUMENTATION**

NOV 10 1997

COMMISSION

LAND CORNER RECORDATION CERTIFICATE

Filing Requirement of Act 74, Mich. P.A. 1970

RECORDED

97 OCT 15 PM 12:15

REGISTER OF DEEDS

Kaye Shultz
SHIAWASSEE COUNTY, MICH.

For corners in

Shiawassee
(County)

Located in:

Corner Code #

Fairfield Twp

- | | | | | | |
|-------------------------|---|----|---|----|------|
| 1. Public Land Survey | T | 8N | R | 1E | D-12 |
| | T | | R | | |
| | T | | R | | |
| | T | | R | | |
| 2. Property Controlling | S | T | R | | |
| in Section | S | T | R | | |
| 3. Miscellaneous | S | T | R | | |
| Property in Sec. | S | T | R | | |

Register of Deeds Stamp & File Number

4. Lot No. _____, Recorded Plat _____
5. Private Claims _____

I, Wendy A. Papineau, in a field survey on June 1997
do hereby certify that under requirements of P.A. 74, Michigan P.A. of 1970, the corner points mentioned in lines 1 and 2 above were in conformance with regulations and rules therefore as required in the current manual of survey instructions of the United States Department of the Interior, Bureau of Land Management or by a decree of a Court of Law and/or that the corner points mentioned in lines 3, 4 and 5 above were in conformance with the rules of the Michigan Board of Land Surveyors or by a Decree of a Court of Law, established, re-established, monumented, re-monumented, recovered, found as expressed below:

NOTE: Not more than 4 corners, all in the same town and range, may be recorded on this certificate.

A. Description of original monument and accessories and/or subsequent restoration:

D-12 Closing 1/4 Corner, Section 32, T8N-R1E

This position was not established by original government survey.

Surveys by O.M. Elliot, C.S. Recorded in Elliot's Field Books, Book 11, P. 47 and Book 27, P. 65, S.C.D.R., 1958

No monument given

East 27' Tele pole (Bk 27, P. 65)

East 52.6' 30" Elm (Bk 27, P. 65)

NW 35.6' Con. Pole (Bk 11, P. 47)

NE 67.8' 14" Oak (Bk 11, P. 47)

Survey by M.L. Vanraemdonck, Sept. 1984, Recorded in L. 4, P. 231, S.C.R. and a L.C.R.C, Recorded in L. 2 P. 399, S.C.R.

Fnd rerod

S20E 63.1' N. end top center 12" CMP

East 2.5' Physical Centerline asphalt

N20W 64.4' W. end Top center 18" CMP

N20E 64.1' E. end Top center 18" CMP

B. Description of corner evidence found and/or method applied in restoring or reestablishing corner:

D-12 Closing 1/4 Corner, Section 32, T8N-R1E

Found record 1/2" rod w/cap #12018 on the Michigan Meridian 2.5' W. of centerline of Meridian Road.

There appears to be no conflicting evidence and this position is accepted as a careful and faithful determination of the position of the corner.

During excavation for placement of Harrison monument, found a 1/2" pipe raised by the 1/2" rod, 1.37' below asphalt. Removed 1/2" pipe and excavated down to a depth of 3', found no more evidence.

Approved by the Shiawassee County Remonumentation Peer Review Group September 4, 1997.

C. Description of monument for corner and accessories established to perpetuate locating the position of the corner:

D-12 Closing 1/4 Corner, Section 32, T8N-R1E

Replaced 1/2" pipe raised by the record 1/2" rod with a standard Harrison monument in a monument

N30W 64.30' Top center of West end of 18" CMP

N40E 64.40' Top center of East end of 18" CMP

S70W 12.50' Set 1/2" rerod in forward slope of ditch

S60E 18.42' Set 1/2" rerod in forward slope of ditch

APPROVED

County Remonumentation
Peer Review Group

NCC
10 OCT 97

Signed by Wendy A. Papineau

Date 10-09-97

Surveyor's Michigan License No. 41919



FORM APPROVED BY MICHIGAN STATE BOARD OF LAND SURVEYORS, JAN. 28, 1971

REVISED MAY 14, 1975

REVISED JAN., 1983

ADAPTED FOR WORD PROCESSING MARCH, 1983

LIBER 1R **PG** 214

BEARINGS ARE BASED ON A
 PREVIOUS REMONUMENTATION
 PROJECT JANUARY THROUGH
 MAY, 1988 BY ROWE ENGINEERING, INC.
 JOB NO. S-4800, AND ALSO A SOLAR
 OBSERVATION AT THE NORTH END OF
 THE 1987 REMONUMENTATION PROJECT

A PORTION OF THE MICHIGAN MERIDIAN

RETRACEMENT AND REMONUMENTATION PROJECT
 FOR
 CLINTON AND SHIAWASSEE COUNTIES, MICHIGAN
 MARCH - SEPTEMBER 1997

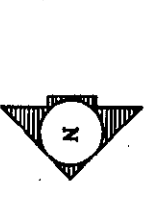

SHEET 1 OF 2 SHEETS

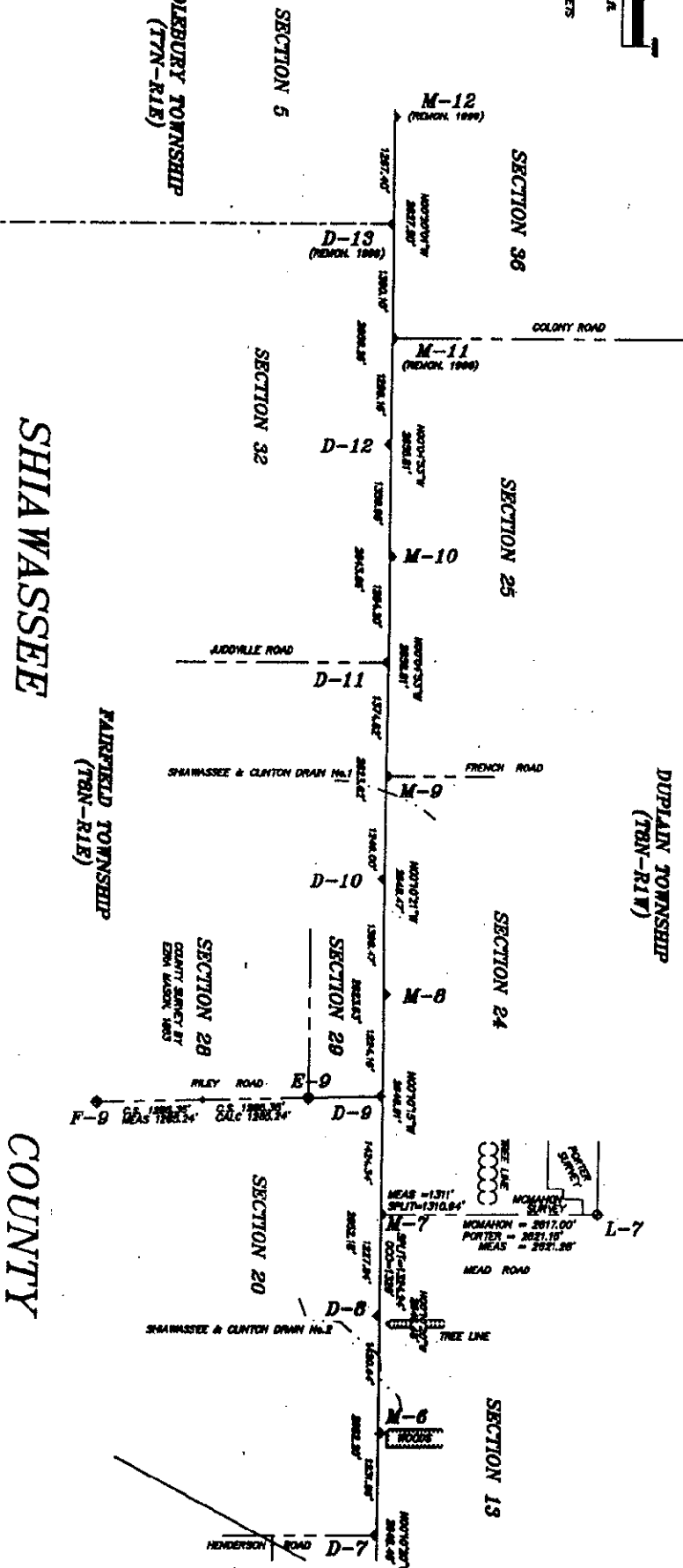

BY
ROWE ENGINEERING, INC.
 112 E. MCARTHUR STREET
 CORUNNA, MI 48837

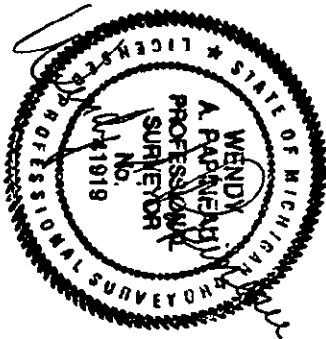

SURVEY &
 REMONUMENTATION
 NOV 10 1997
 COMMISSION