

MAY 16 1997

Van Buren County Remonumentation Program

Dec 20 2 47 PM '96

COMMISSION

LAND CORNER RECORDATION CERTIFICATE

Filing Requirement of Act 74, Mich. P.A. 1970

Section Corner 22, 23, 26, 27

Mark A. Smith  
VAN BUREN CO.  
REGISTERED DEEDS

For corners in Arlington Township

Van Buren

(County)

Located in:

Corner Code #

1. Public Land Survey

T 2S R 15W 19  
T R  
T R

2. Property Controlling in Section

S T R Ratified by Peer Group in  
S T R accordance with P.A. 345 of 1996  
S T R Van Buren County Surveyor

3. Miscellaneous Property in Sec.

S T R  
Date 12/20/96 D. R. A.

4. Lot No. , Recorded Plat

5. Private Claims

I, Gary C. Bilow, in a field survey on 5/28, 1993 do hereby state that under requirements of P.A. 74, Michigan P.A. of 1970, the corner points mentioned in lines 1 and 2 above were in conformance with regulations and rules therefore as required in the current manual of survey instructions of the United States Department of the Interior, Bureau of Land Management or by a decree of a Court of Law and/or that the corner points mentioned in lines 3, 4 and 5 above were in conformance with the rules of the Michigan Board of Land Surveyors or by a Decree of a Court of Law; established, re-established, monumented, recovered, found as expressed below:

NOTE: Not more than 2 corners, all in the same town and range, may be recorded on this certificate.

	A	B	C	D	E	F	G	H	I	J	K	L	M
1													
2		6		5		4		3		2		1	
3													
4		7		8		9		10		11		12	
5													
6		18		17		16		15		14		13	
7													
8		19		20		21		22		23		24	
9													
10		30		29		28		27		26		25	
11													
12		31		32		33		34		35		36	
13													

A. Description of original monument and accessories and/or subsequent restoration:

Post established by U.S. Deputy Surveyor G. Harrison in 1830 - accessories: Beech 20 S73E 39 links and White Ash 4 West 1 link. County Surveyor C.D. Lawton recorded in 1868 in Volume 2 Page 49 "Stone - accessories: Sugar NW .78, Sugar NE .35, Sugar SW .65." County Surveyor W.H. Goss recorded in 1905 in Volume 6 Page 178 "Found Stone and brick and two (2) of Lawton's accessories." County Surveyor T.A. Smith recorded in 1927 in his field notes "Found corner - accessories: 12" Maple S52E 49.0' to center, 12" Maple S47W 43.2' to center, 24" Maple N50W 53.0' to center, 12" Walnut N21E 59.5' to center." E. Stefan (PS #13599) lists an Iron pipe and states that the witnesses are on an Act 132 Survey which is recorded in Liber 3 Page 135 (survey was not found).

B. Description of corner evidence found and/or method applied in restoring or reestablishing corner:

Found a RR spike and one (1) of Smith's accessories. The distance that Stefan reports on his survey between corners 19 and 18 checked within reason. Accepted RR spike as the best evidence of the original GLO post.

THIS GOVERNMENT MONUMENT WAS RESTORED WITH THE APPROVAL OF THE VAN BUREN COUNTY REMONUMENTATION PEER GROUP OF SURVEYORS AT A MEETING HELD OCTOBER 9, 1996, AND IS ACCEPTED AS A CAREFUL AND FAITHFUL PERPETUATION OF THE POSITION OF THE ORIGINAL CORNER.

C. Description of monument for corner and accessories established to perpetuate locating the position of the corner:

Replaced RR spike with Harrison Monument on 12/18/96

N60°W 53.71' spike in 30" Maple  
N86°E 50.4' Street/Stop Sign post  
S70°W 50.2' Stop sign post  
South 6' centerline 40th Avenue  
West 1.5' centerline County Road 673  
S50°W 60.35' PK nail in 40" Maple

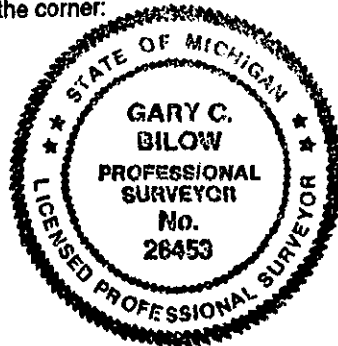

Signed by Gary C. Bilow  
Surveyor's Michigan License No. 26453

Date December 19, 1996