

SURVEY &  
REMONUMENTATION

JAN 11 1999

FILED

Nov 19 9 15 AM '90

SECTION

LAND CORNER RECORDATION CERTIFICATE  
Filing Requirement of Act 74, Mich. P.A. 1970

For corners in

Van Buren Located In: Corner Code #  
(County) NW Cor. Sec. 26, Antwerp Township

1. Public Land Survey T 3 S R 13 W 1-9  
T     R      
T     R      
T     R      
2. Property Controlling S     T     R      
in Section S     T     R      
3. Miscellaneous S     T     R      
Property in Sec. S     T     R    

*Mark A. Smith*  
VAN BUREN CO.  
REGISTER OF DEEDS  
LIBER 5 PAGE 124  
Register of Deeds Stamp & File Number

4. Lot No.           , Recorded Plat             
5. Private Claims           

I, James E. Boynton, in a field survey on           , 1997  
do hereby certify that under requirements of P.A. 74, Michigan P.A. of 1970, the corner points  
mentioned in lines 1 and 2 above were in conformance with regulations and rules therefore as  
required in the current manual of survey instructions of the United States Department of the  
Interior, Bureau of Land Management or by a decree of a Court of Law and /or that the corner  
points mentioned in lines 3, 4 and 5 above were in conformance with the rules of the Michigan  
Board of Land Surveyors or by a Decree of a Court of Law; established, re-established,  
monumented, re-monumented, recovered, found as expressed below:

NOTE: Not more than 4 corners, all in the same town and range, may be recorded  
on this certificate.

	A	B	C	D	E	F	G	H	I	J	K	L	M
1													
2		6		5		4		3		2		1	
3													
4		7		8		9		10		11		12	
5													
6		18		17		16		15		14		13	
7													
8		19		20		21		22		23		24	
9													
10		30		29		28		27		26		25	
11													
12		31		32		33		34		35		36	
13													

- A. Description of original monument and accessories and/or subsequent restoration:  
Original corner position established in 1829 by William Brookfield, D.S. In 1973 W. Q. Smith found and used a 1-1/4" pipe. In 1988 D. R. Gilchrist found and used the 1-1/4" pipe.
- B. Description of corner evidence found and/or method applied in restoring or reestablishing corner:  
Found a 1/2" iron bar at surface of road over a 1-1/4" pipe and accepted the pipe as the best available evidence of the corner location.
- C. Description of monument for corner and accessories established to perpetuate locating the position of the corner:  
Set Standard Remon Monument in place of the pipe as directed by the Peer Group during the regular meeting of July 30, 1998.  
MON. IS 8.6' WEST OF THE CENTERLINE OF ROAD  
18" OAK N.11°-45'E. 85.32' TO NAIL  
24" OAK S.50°-44' E. 59.42' TO NAIL  
18" CHERRY S.88°-41' W. 43.08' TO NAIL  
12" HICKORY N.53° W. 9.69' TO NAIL

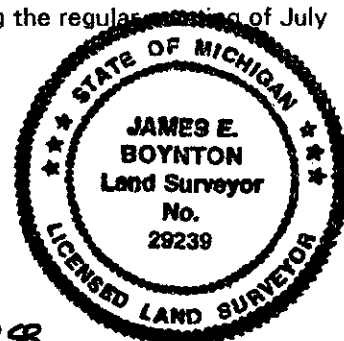

Signed by James E. Boynton Date 11-17-98  
Surveyor's Michigan License No. 29239

Ratified by Peer Group in  
accordance with P.A. 345 of 1990  
Van Buren County Surveyor

Date D.R.A. 11/19/98

FORM APPROVED BY MICHIGAN STATE BOARD OF LAND SURVEYORS, JAN. 28, 1971  
REVISED MAY 14, 1976  
REVISED JAN., 1983