

LAND CORNER RECORDATION CERTIFICATE
Filing Requirement of Act 74, Mich. P.A. 1970

\$ 4.00 REMONUMENTATION

\$ 10.00 DEED

DEC 95 10:24 A.M.

RECEI

A

RECORDED

FOREST E. YOUNGBLOOD, REGISTER
WAYNE COUNTY, MI

EDS

For corners in

WAYNE

(County)

Located In:
City of Detroit

OTHER

Corner Code #

LIBER 28465 PAGE 738

Compliance with
ACT 345, P.A. 1990

APPROVED ON: 12-11-95
WAYNE COUNTY REMONUMENTATION
PEER GROUP COMMITTEE

Register of Deeds Stamp & File Number

1. Public Land Survey T 2S R 11E Protracted
T R Location
T R # 006
T R
2. Property Controlling S T R
in Section S T R
3. Miscellaneous S T R
Property in Sec. S T R

4. Lot No. , Recorded Plat
5. Private Claims Rear line of Private Claim 228

NE Corner of P.C. 228

I, George M. Platz, in a field survey on December 11, 19 95, do hereby certify that under requirements of P.A. 74, Michigan P.A. of 1970, the corner points mentioned in lines 1 and 2 above were in conformance with regulations and rules therefore as required in the current manual of survey instructions of the United States Department of the Interior, Bureau of Land Management or by a decree of a Court of Law and/or that the corner points mentioned in lines 3, 4 and 5 above were in conformance with the rules of the Michigan Board of Land Surveyors or by a Decree of a Court of Law; established, re-established, monumented, re-monumented, recovered, found as expressed below:

NOTE: Not more than 4 corners, all in the same town and range, may be recorded on this certificate.

A. Description of original monument and accessories and/or subsequent restoration:
The Rear Line of P.C. 228

City of Detroit

The rear line of P.C. 228 was surveyed as a straight line in 1810 (see research dossier for sketch and notes). This line is adjacent to fractional Section 1, T2S., R11E. Posts were originally set at the corners only and no line stakes are called out. Five subdivisions have been platted adjacent to this line, delineating it with dimension and bearing. These subdivisions created/show a deflection in this line. The City of Detroit Survey Section has assembled and maintained their "Cartographical Maps" from record plat data and field work. These maps have been relied upon for a great number of years and are considered the best assembled collection of written evidence available. To the best of my knowledge, there has never been any subsequent restoration of this line, excepting the plats which were done long ago.

B. Description of corner evidence found and/or method applied in restoring or reestablishing corner:
The Rear Line of P.C. 228

A complete analysis of this line from its eastern end at the line common to Private Claims 228 and 227 to its western end at the line common to P.C. 228 and 726 has been field measured by Spalding DeDecker & Associates, locating street lines, alley lines, fence lines, trees, and other occupation. Based upon the facts obtained at these various positions (see research dossier). It is my conclusion that a deflection does take place at the centerline of the alley between "Candlers Subdivision" and "J. McMillan's Endensor Subdivision". The specific points held as good and their relationships with the other various points field measured/computed are labeled in the research dossier.

C. Description of monument for corner and accessories established to perpetuate locating the position of the corner:
The Rear Line of P.C. 228 -- See Sketch on back of this sheet.

A) Set 4"x 36" Concrete Monument w/Brass Disk stamped "WAYNE COUNTY REMONUMENTATION", and Plastic Cap stamped "PS 38121" in a Monument Box Located at the intersection of the Rear line of P.C. 228 with the eastern line of P.C. 228. The location of this property controlling monument is accepted as a careful and faithful determination of this private claim line based upon all known evidence.

Az. 94° 227.45'; Set P.K. Nail w/WCR Tag in N. Face of Utility Pole
Az. 157° 83.24'; Set P.K. Nail w/WCR Tag in W. Face of Utility Pole
Az. 178° 40.25'; Set P.K. Nail w/WCR Tag in E. Face of Utility Pole
Az. 285° 58.16'; Set P.K. Nail w/WCR Tag in S. Face of 29" Tree
Az. 347° 35.63'; Set P.K. Nail w/WCR Tag in E. Face of Utility Pole

Signed by George M. Platz

Date 12-11-95

Surveyor's Michigan License No. 38121

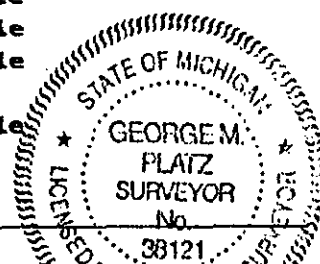

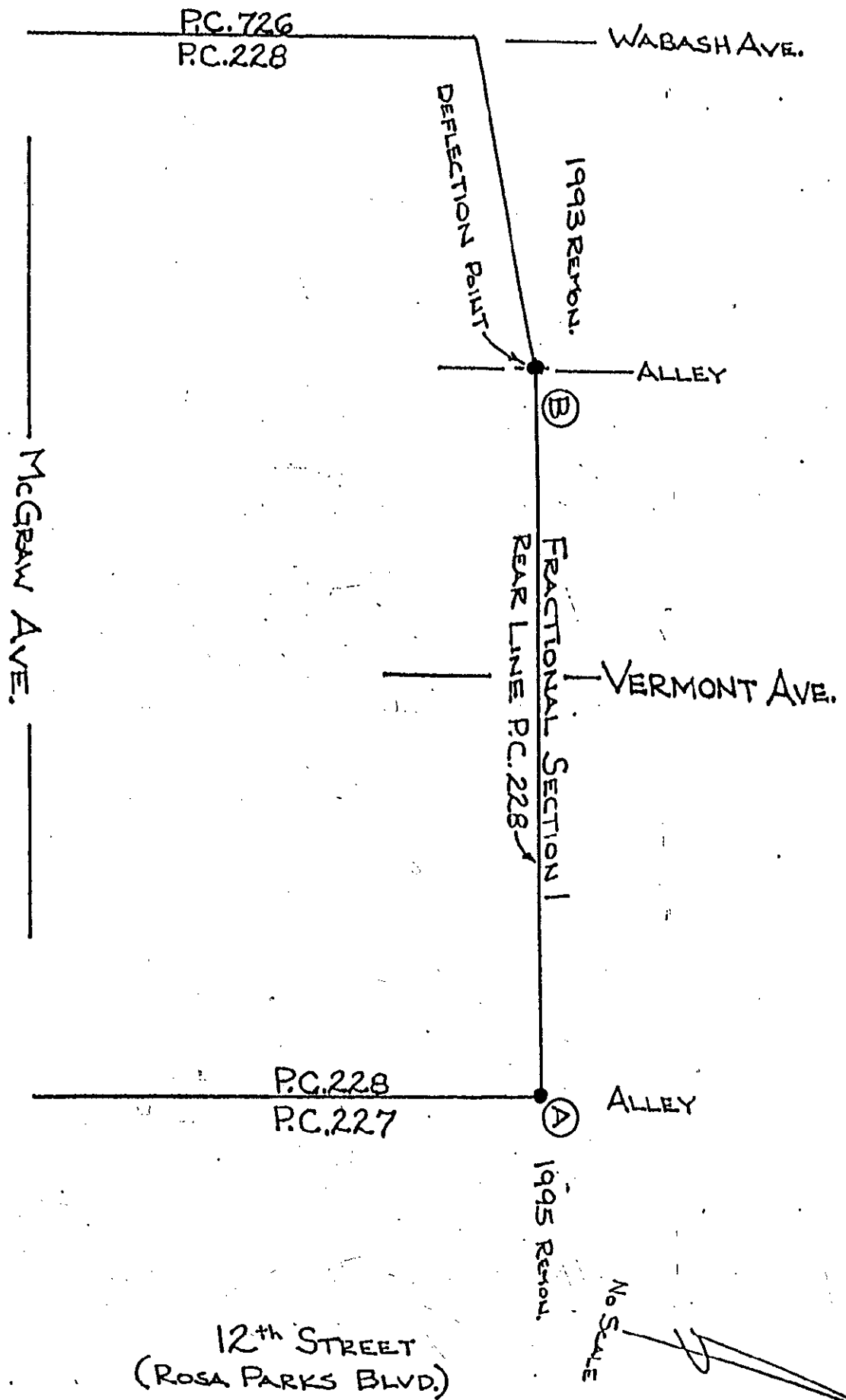

FILED DO NOT MAIL