

LAND CORNER RECORDATION CERTIFICATE
Filing Requirement of Act 74, Mich. P.A. 1970

For corners in

Wayne
(County)

Located In:

OTHER

Corner Code # 9

1. Public Land Survey T 25 R 12E #009
T R
T R
T R
2. Property Controlling S T R
in Section S T R
3. Miscellaneous S T R
Property in Sec. S T R

Compliance with
ACT 345, P.A. 1990

APPROVED ON: 12-8-93
WAYNE COUNTY REMONUMENTATION
PEER GROUP COMMITTEE

Register of Deeds Stamp & File Number

4. Lot No. Recorded Plat
5. Private Claims Eastern Line Private Claim 55

| | A | B | C | D | E | F | G | H | I | J | K | L | M |
|----|----|---|----|---|----|---|----|---|----|---|----|---|---|
| 2 | 6 | | 5 | | 4 | | 3 | | 2 | | 1 | | |
| 3 | | | | | | | | | | | | | |
| 4 | 7 | | 8 | | 9 | | 10 | | 11 | | 12 | | |
| 5 | | | | | | | | | | | | | |
| 6 | 18 | | 17 | | 16 | | 15 | | 14 | | 13 | | |
| 7 | | | | | | | | | | | | | |
| 8 | 19 | | 20 | | 21 | | 22 | | 23 | | 24 | | |
| 9 | | | | | | | | | | | | | |
| 10 | 30 | | 29 | | 28 | | 27 | | 26 | | 25 | | |
| 11 | | | | | | | | | | | | | |
| 12 | 31 | | 32 | | 33 | | 34 | | 35 | | 36 | | |
| 13 | | | | | | | | | | | | | |

I, George M. Platz, in a field survey on November 15, 1993, do hereby certify that under requirements of P.A. 74, Michigan P.A. of 1970, the corner points mentioned in lines 1 and 2 above were in conformance with regulations and rules therefore as required in the current manual of survey instructions of the United States Department of the Interior, Bureau of Land Management or by a decree of a Court of Law and/or that the corner points mentioned in lines 3, 4 and 5 above were in conformance with the rules of the Michigan Board of Land Surveyors or by a Decree of a Court of Law; established, re-established, monumented, re-monumented, recovered, found as expressed below:

NOTE: Not more than 4 corners, all in the same town and range, may be recorded on this certificate.

A. Description of original monument and accessories and/or subsequent restoration:

LINE COMMON TO P.C. 55 AND 'THE DETROIT COMMONS'

THE EASTERN LINE OF P.C. 55 WAS ORIGINALLY SURVEYED IN TWO SEPARATE TRACTS OF LAND, THE FIRST IN THE YEAR 1810 BY AARON GREELEY AND THE SECOND IN 1829 BY SYLVESTER SIBLEY (SEE RESEARCH DOSSIER FOR SKETCH AND NOTES). THIS LINE IS ADJACENT TO THE WESTERN LINE OF THE 'DETROIT COMMONS'. POSTS WERE ORIGINALLY SET AT THE CORNERS ONLY AND NO LINE STAKES ARE CALLED OUT. MANY SUBDIVISIONS HAVE BEEN PLATTED ADJACENT TO THIS LINE, SOME DELINEATING IT WITH DIMENSION, OTHERS NOT. THE CITY OF DETROIT SURVEY BUREAU HAS ASSEMBLED AND MAINTAINED THEIR 'CARTOGRAPHICAL MAPS' FROM RECORD PLAT DATA AND FIELD WORK. THESE MAPS HAVE BEEN RELIED UPON FOR A GREAT NUMBER OF YEARS AND ARE CONSIDERED THE BEST ASSEMBLED COLLECTION OF WRITTEN EVIDENCE AVAILABLE. TO THE BEST OF MY KNOWLEDGE, THERE HAS NEVER BEEN ANY SUBSEQUENT RESTORATION OF THIS LINE, EXCEPTING THE PLATS WHICH WERE DONE LONG AGO.

B. Description of corner evidence found and/or method applied in restoring or reestablishing corner:

LINE COMMON TO P.C. 55 AND 'THE DETROIT COMMONS'

A COMPLETE ANALYSIS OF THIS LINE FROM ITS SOUTHERN BEGINNINGS AT THE DETROIT RIVER TO ITS NORTHERN TERMINUS JUST NORTH OF AMSTERDAM STREET HAS BEEN FIELD MEASURED BY SPALDING, DEDECKER AND ASSOCIATES, LOCATING BUILDING LINES, STREET LINES AND ALLEY LINES AT VARIOUS POSITIONS (SEE RESEARCH DOSSIER). IT IS MY CONCLUSION THAT A DEFLECTION TAKES PLACE AT THE APPROXIMATE LOCATION OF THE REAR CONCESSION LINE (THE JOINING TOGETHER OF THE 1810 AND 1829 SURVEY). THE SPECIFIC POINTS HELD AS GOOD AND THE RELATIONSHIP OF THE OTHER VARIOUS POINTS FIELD MEASURED ARE LABELED IN THE RESEARCH DOSSIER.

C. Description of monument for corner and accessories established to perpetuate locating the position of the corner:

- (C) SET MONUMENT WITH WAYNE COUNTY REMONUMENTATION TAG AND LICENSE CAP NO. 38121 IN MONUMENT BOX IN PAVEMENT AT THE EASTERN RIGHT-OF-WAY LINE OF CASS AVENUE AND APPROXIMATELY 17' NORTH OF THE CENTERLINE OF CANFIELD AVENUE. THE LOCATION OF THIS PROPERTY CONTROLLING MONUMENT IS ACCEPTED AS A CAREFUL AND FAITHFUL DETERMINATION OF THE POSITION OF THIS PRIVATE CLAIM LINE BASED UPON ALL KNOWN EVIDENCE.

AZ. 51° 31.61'; SET PK NAIL WITH WCR TAG IN CONCRETE SIDEWALK
AZ. 166° 41.02'; CENTERLINE TOP NUT ON HYDRANT
AZ. 218° 85.51'; SET PK NAIL WITH WCR TAG IN TOP OF TRAFFIC SIGNAL POLE BASE
AZ. 344° 43.58'; SET PK NAIL WITH WCR TAG IN TOP OF TRAFFIC SIGNAL POLE BASE

Signed by George M. Platz

SURVEY &
REMONUMENTATION

Date 12-3-93

Surveyor's Michigan License No. 38121

JAN 26 1999

SECTION

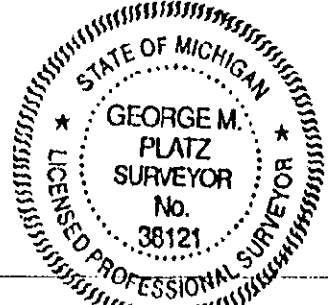

LI27018^{PA}411

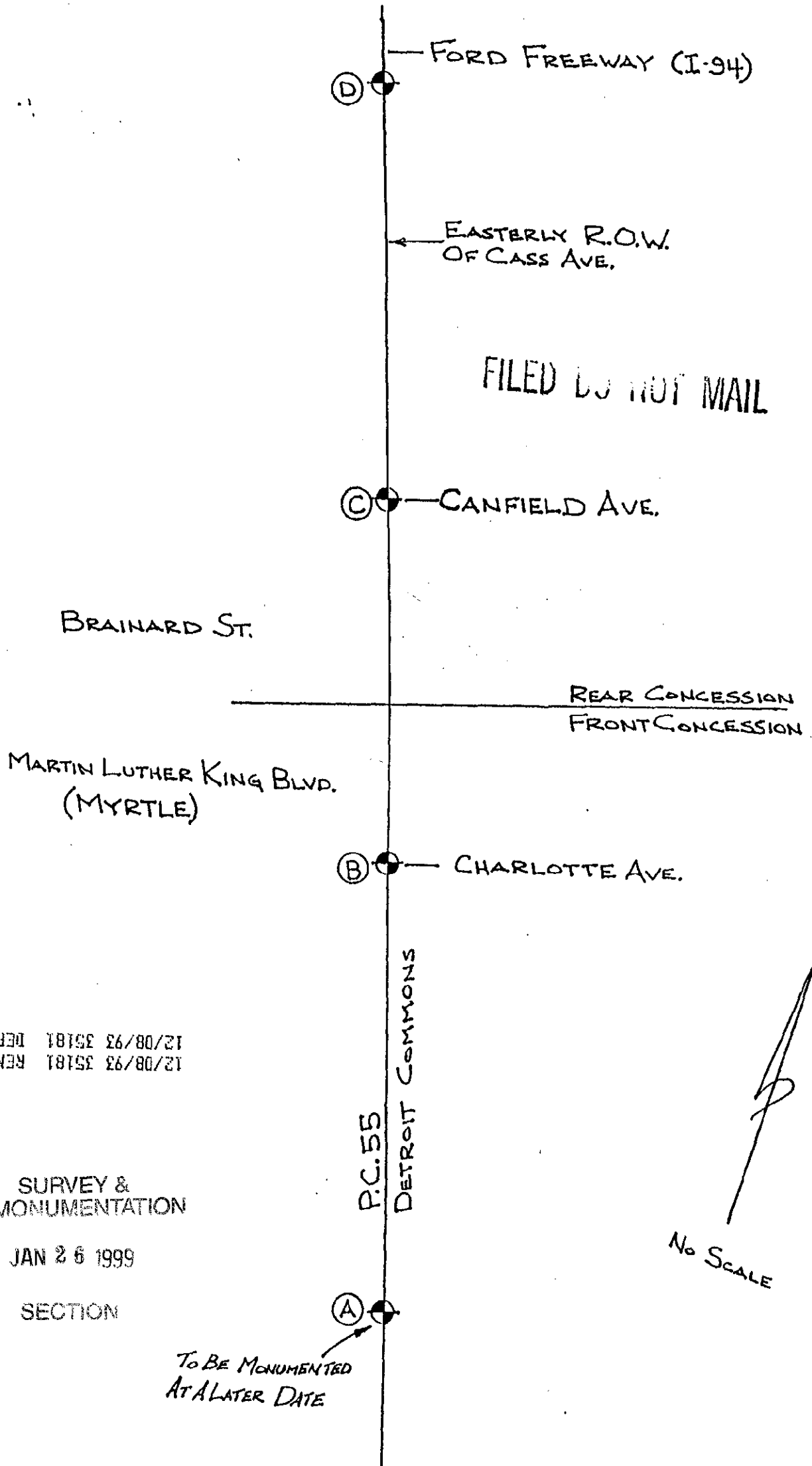

12/08/93 35181 REMO FEE 2.00
12/08/93 35181 DEED 14.00

SURVEY &
REMONUMENTATION

JAN 26 1999

SECTION