

FILE DO NOT MAIL

LAND CORNER RECORDATION CERTIFICATE  
Filing Requirement of Act 74, Mich. P.A. 1970

FEB 28 2000

For corners in

Wayne, Van Buren Twp.

(County)

Located In:

Corner Code #

SECTION

Liber-30845 Page-18  
99592658 12/28/1999

F.E. Youngblood, Wayne Co. Register of Deeds  
RDANDSYL

Compliance with  
ACT 345, P.A. 1990

APPROVED ON: DEC 9, 1999  
WAYNE COUNTY REMONUMENTATION  
PEER GROUP COMMITTEE

Register of Deeds Stamp & File Number

1. Public Land Survey

3S. 8E. J-1  
T R  
T R  
T R  
T R  
S T R  
S T R  
S T R  
S T R

2. Property Controlling  
in Section

3. Miscellaneous  
Property in Sec.

4. Lot No. , Recorded Plat

5. Private Claims

I, William L. Roskelly, in a field survey on Dec 5, 1999 do hereby state that under requirements of P.A. 74, Michigan P.A. of 1970, the corner points mentioned in lines 1 and 2 above were in conformance with regulations and rules therefore as required in the current manual of survey instructions of the United States Department of the Interior, Bureau of Land Management or by a decree of a Court of Law and/or that the corner points mentioned in lines 3, 4 and 5 above were in conformance with the rules of the Michigan Board of Land Surveyors or by a Decree of a Court of Law; established, re-established, monumented, recovered, found as expressed below:

NOTE: Not more than 2 corners, all in the same town and range, may be recorded on this certificate.

|    | A  | B | C | D  | E | F  | G | H  | I | J  | K | L  | M |
|----|----|---|---|----|---|----|---|----|---|----|---|----|---|
| 1  |    |   |   |    |   |    |   |    |   |    |   |    |   |
| 2  | 6  |   |   | 5  |   | 4  |   | 3  |   | 2  |   | 1  |   |
| 3  |    |   |   |    |   |    |   |    |   |    |   |    |   |
| 4  | 7  |   |   | 8  |   | 9  |   | 10 |   | 11 |   | 12 |   |
| 5  |    |   |   |    |   |    |   |    |   |    |   |    |   |
| 6  | 18 |   |   | 17 |   | 16 |   | 15 |   | 14 |   | 13 |   |
| 7  |    |   |   |    |   |    |   |    |   |    |   |    |   |
| 8  | 19 |   |   | 20 |   | 21 |   | 22 |   | 23 |   | 24 |   |
| 9  |    |   |   |    |   |    |   |    |   |    |   |    |   |
| 10 | 30 |   |   | 29 |   | 28 |   | 27 |   | 26 |   | 25 |   |
| 11 |    |   |   |    |   |    |   |    |   |    |   |    |   |
| 12 | 31 |   |   | 32 |   | 33 |   | 34 |   | 35 |   | 36 |   |
| 13 |    |   |   |    |   |    |   |    |   |    |   |    |   |

A. Description of original monument and accessories and/or subsequent restoration:

J-1 North corner section 2, T.3 S., R.8 E., Van Buren Township

G.L.O. (1830's) J Wampler set corner post, witnesses: Sycamore 18 S3 E15, Wal't 14 N 17 E 25

W.P.A. (1930's) stone, witnesses: NE 32.55' 14" Apple (gone), E 284' +/- iron (gone), SE 57.18' 5" Elm (gone), SW 79.32' 20" Elm (gone), SW 70.00' 20" Oak (gone), NW 17.87' Ed. pole (gone). W.C.R.C. found iron, witnesses N 17.87' Ed. Pole (gone), NE 32.35' 10" Apple (gone), E 279.68' iron (M= 279.79'), SE 37.18' 5" Elm (gone), SW 79.32' 20" Elm (gone), SW 70.00' Oak (gone).

B. Description of corner evidence found and/or method applied in restoring or reestablishing corner:

J-1 North corner section 2, T.3 S., R.8 E., Van Buren Township

Found an iron pipe cap ALG 24618.

Verified corner location by comparing W.P.A. data with field measurements:

J-1 to I-1 Record = 2834.68' Measured = 2834.66' J-1 to K-1 Record = 2832.30' Measured = 2832.92'

Angle line J-1 & I-1 to J-1 & K-1 Record = 179° -23' -10" Measured = 179° -34' -54"

W.C.R.C. E 279.68' iron (M= 279.79').

C. Description of monument for corner and accessories established to perpetuate locating the position of the corner:

J-1 North corner section 2, T.3 S., R.8 E., Van Buren Township

Set concrete monument.

The selected location is accepted by the contractor and is generally accepted by professional surveyors as the best available evidence of the position of the corner. WITNESSES: Found mon box iron pipe J-13 Canton Twp. N.88°21'41"E. 279.79', set nail & WCR tag N face light pole S.73° 18' 44" E. 158.44', found NE corner "Great Lakes Towing Bldg." S.54° 05'53"E. 144.16', set WC ref tag E face light pole S.13° 35' 39"E. 81.71', set nail WCR tag SE face P. pole S.41° 11' 58" W. 85.08', top chain link fence N.88° 56' 07" W. 67.63', set nail WCR tag E face P. pole N.10° 36'55"W. 19.31'. Note: Corner J-1 is not a common corner. I-13 Canton Twp. S 4.40' of township line and J-13 Canton Twp. is N 2.53' of township line.

Set PK nail and Wayne County Remonumentation brass marker and B&S #10705.

Signed by

William L. Roskelly

Surveyor's Michigan License No. 10705

Date 12-28-99

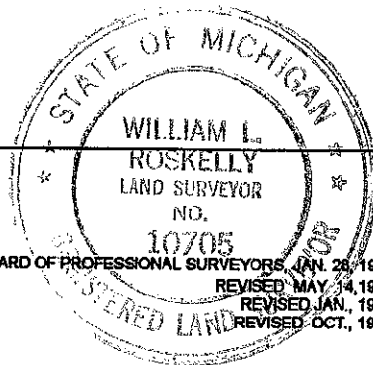

FORM APPROVED BY MICHIGAN STATE BOARD OF PROFESSIONAL SURVEYORS, JAN. 28, 1971  
REVISED MAY 31, 1975  
REVISED JAN., 1983  
REVISED OCT., 1995

R LCR 9 4R 1 Pg A DPZ