

Township N° 50 N. Range N° 32 W. Mer. Mich.

Range 2 W. Range 3 W.

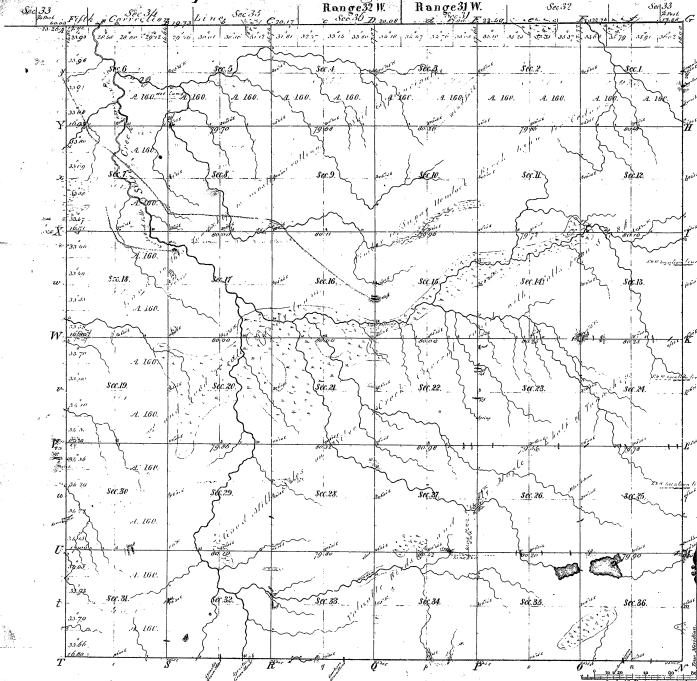

Bearings of		Course	Dist.	Bearing of		Course	Dist.
Front	Course			Front	Course		
<p>14° 1</p>							
<p>1</p>							
<p>2</p>							
<p>3</p>							
<p>4</p>							
<p>5</p>							
<p>6</p>							
<p>7</p>							
<p>8</p>							
<p>9</p>							
<p>10</p>							
<p>11</p>							
<p>12</p>							
<p>13</p>							
<p>14</p>							
<p>15</p>							
<p>16</p>							
<p>17</p>							
<p>18</p>							
<p>19</p>							
<p>20</p>							
<p>21</p>							
<p>22</p>							
<p>23</p>							
<p>24</p>							
<p>25</p>							
<p>26</p>							
<p>27</p>							
<p>28</p>							
<p>29</p>							
<p>30</p>							
<p>31</p>							
<p>32</p>							
<p>33</p>							
<p>34</p>							
<p>35</p>							
<p>36</p>							

Note:  
 The West half of this Township purchased from State  
 by order of the President See Act of Congress March 3rd  
 1820  
 Land Office dated March 20<sup>th</sup> 1822

Total number of Acres.

Survey Designated	By Whom Surveyed	Date of Grabrod	Amount of Acres	When Surveyed	When Made and by Whom
Township lines	William W. Beck	Sept 7. 1816	36 05 12 1/2	1816	1816
Subdivisions	William W. Beck	June 21. 1822	49 24 9 1/2	1822	1822

The above map of Township N° 50 N. West of Range N° 32 West of the  
 Principal Meridian. Shows corners as actually found in the field notes  
 of the survey placed on file in this office which have been reviewed and approved

Surveyor General's Office  
 Detroit, March 18 1822  
 Charles F. Rice  
 Surveyor

45-1